



SWING CHECK VALVE

Model: KVS - 103



SPECIFICATION

- Designed to BS 5153
- Pressure Rating: PN16, PN25
- Working Medium: Water, Oil
- Working temperature: -10...+120°C
- Flanged to BS 4504 / BS EN 1092-2
- Horizontal Swing Pattern
- Bolted Cover
- Suitable for mouting in horizontal and vertical pipe
- Lever & Weight and Air Cushion check valves available upon request.
- Other flange standards available upon request
- ANSI standards available upon request

SWING CHECK VALVE

Model: KVS - 103

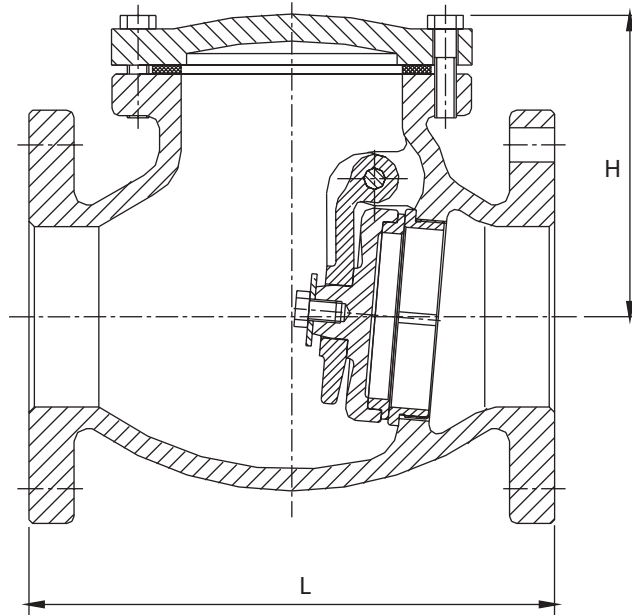

MATERIALS

Description	Material
Body	Cast Iron / Ductile Iron
Trim(body & disc ring)	Bronze
Disc	Ductile Iron
Locking Nut	Carbon Steel
Arm	Ductile Iron
Hinge Pin	Stainless Steel
Bonnet	Cast Iron

DIMENSIONS (mm)

Size	Inches	2"	2 1/2"	3"	4"	5"	6"	8"
	mm	50	65	80	100	125	150	200
H		121	135	141	168	192	215	267
L		203	216	241	292	330	356	495

Size	Inches	10"	12"	14"	16"	18"	20"	24"
	mm	250	300	350	400	450	500	600
H		305	343	450	520	550	590	680
L		622	699	787	914	914	1016	1219