



NRS GATE VALVE

Model : KVS - 4151



SPECIFICATION

- Model : KVS-4151
- Dimensions: 2.1/2" - 12" (DN65 - DN300)
- Nominal Pressure: 300 psi (20,6 bar)
- Working Temperature : -10...120°C
- Connections: Flange ends
- Epoxy coating, external and internal

STANDARD

- Certificate: UL, FM
- Design: FM 1120/1130, UL 262
- Tests: FM 1120/1130, UL 262
- Standards: TS ISO 7005-5



Such valves are used to shut off and to control main lines and underground water lines in hydrant systems. They can be used with a post indicator showing the on/off position. When used with post indicator below ground, no valve chamber will be required.

MATERIAL SPECIFICATIONS

Part Name	Material
Body	DUCTILE IRON
Sealing Gland	EPDM
O-Ring	EPDM
Bonnet	DUCTILE IRON
Stem	SS304
Disc	DUCTILE IRON + EPDM
Sealing Ring	DUCTILE IRON
Gland	C95400
Nut	SS304
Studs	SS304
Spring Washer	STEEL
Washer	STEEL
Inner Hexagon Screw	STEEL



NRS GATE VALVE

Model : KVS - 4151

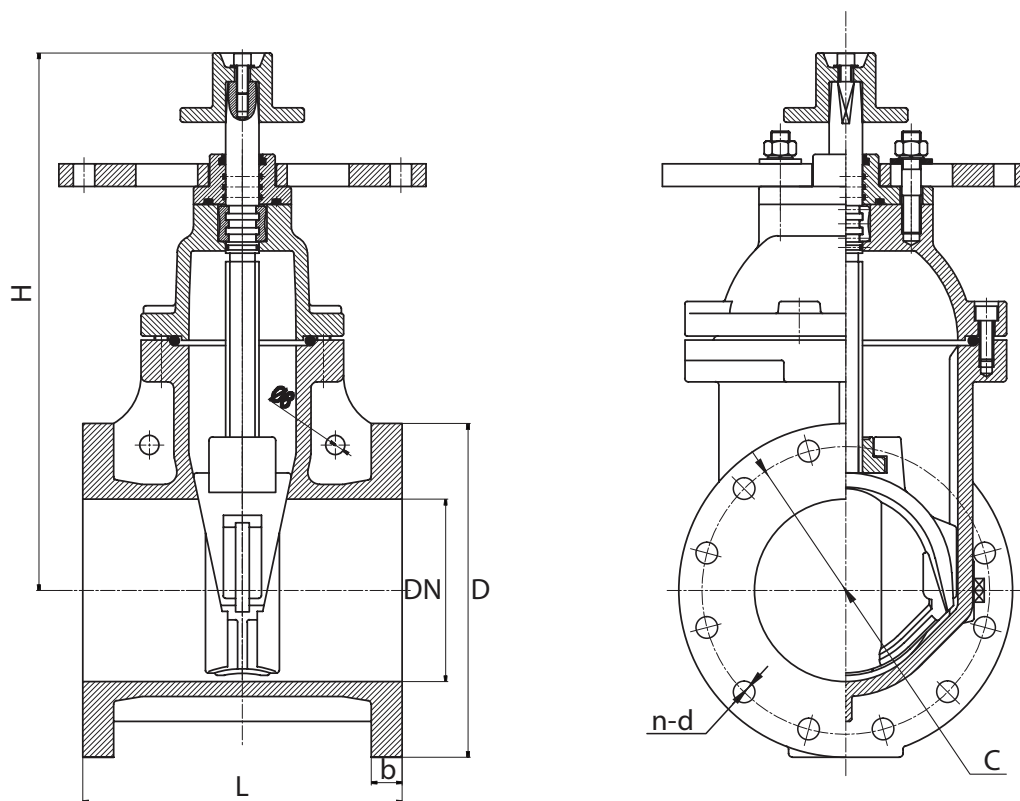

DIMENSION (mm)

PN		300 psi (20,6 bar)					
DN		L	D	b	c	n-d	H
Inches	mm						
2 1/2"	65	190	178	17.5	139.5	4-ø19	292
3"	80	203	191	21	152.5	4-ø19	322
4"	100	229	229	24	190.5	8-ø19	342
5"	125	254	254	23.9	216	8-ø22	412
6"	150	267	279	25.4	241.5	8-ø22	448
8"	200	292	343	28.6	298.5	8-ø22	534
10"	250	330	406	30.2	362	12-ø25	635
12"	300	356	483	31.8	432	12-ø25	720