



# SWING CHECK VALVE

Model : KVS - 1151



## SPECIFICATION

- Model : KVS-1151
- Dimensions: 2.1/2" - 12" (DN65 - DN300)
- Nominal Pressure: 300 psi (20,6 bar)
- Working Temperature : -10...120°C
- Connections: Flange ends
- Epoxy coating, external and internal

## STANDARD

- Certificate: UL, FM
- Standards: TS ISO 7005-5



Permits the flow of the fluid in only one direction. Due to the amount of pressure losses the use of multiple check valves is rather not requested in fire protection systems.

## MATERIAL SPECIFICATIONS

Part Name	Material
Body	ASTM A356
Bonnet	ASTM A356
Seat Ring	ASTM A148 C95400
Disc	ASTM A536
Baffle Plate	ASTM A148 C95400
Stem	ASTM A276 SS304
Bracket Screw	ASTM A276 SS304
Gasket	ASTM A276 SS304
O-Ring (Mid Stem)	ASTM D2000 EPDM
Nut	ASTM A276 SS304
Bolt	STEEL



# SWING CHECK VALVE

Model : KVS - 1151

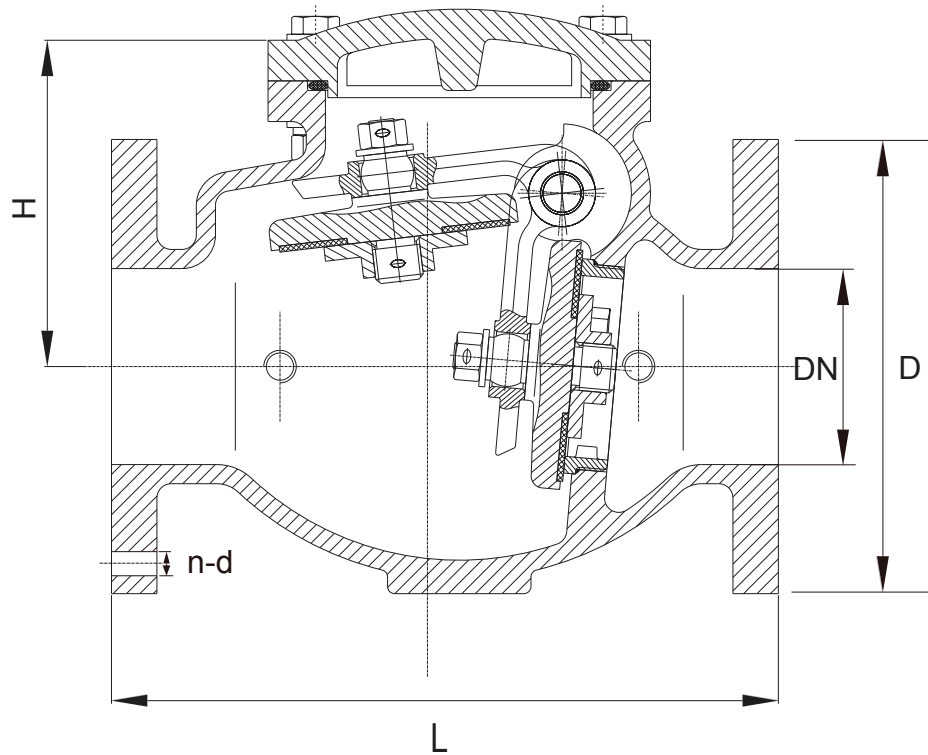

## DIMENSION (mm)

DN		300 psi (20,6 bar)					
Valve Dimensions		DN	L	D	c	n-d	H
Inches	mm						
2 1/2"	65	64	216	178	139.5	4-ø19	148
3"	80	80	241	191	152.5	4-ø19	163.5
4"	100	100	292	229	190.5	8-ø19	172
5"	125	126	330	254	216	8-ø22	237
6"	150	152	356	279	241.5	8-ø22	233
8"	200	204	495	343	298.5	8-ø22	301
10"	250	254	622	406	362	12-ø25	348
12"	300	302	698	483	432	12-ø25	419