



MULTI-JET DRY VERTICAL WATER METER

Mode : MTM- 65



SPECIFICATION

- Body material: Ductile Iron
- Magnetic drive, lower transmission resistance.
- Magnetic shield, for external magnetic field protection
- Sealed dry dial register ensures clear reading.
- Internal strainer, inlet strainer for selecting
- ISO 4064 Class A/B Standard
- Working temperature: Max. 50°C for cold water, Max. 90°C for hot water
- Working pressure: 1.0 MPa
- The meter should be installed in horizontal position
- The meter should be constantly full of water during operation

DIMENSIONS (mm)

Meter size Dia DN(mm)	Class	q_5 Overload Flow	q_5 Nominal Flow	q_5 Transitional Flow	Qmin Min Flow	Min Reading Lectura	Max Reading Lectura
		m ³ /h		l/h		m ³	
15	A	3	1.5	150	60	0.0001	99999
	B			120	30		
20	A	5	2.5	250	100	0.0001	99999
	B			200	50		
25	A	7	3.5	350	140	0.0001	99999
	B			280	70		



MULTI-JET DRY VERTICAL WATER METER

Mode : MTM- 65

INDICATING ERROR

At low zone is $\pm 5\%$ from minimum flow rate (q_{min}) to transitional flow rate (q_t) exclusive boundary
 At high zone is $\pm 2\%$ from transitional flow rate (q_t) to overload flow rate (q_s)

FLOW-ERROR CURVE

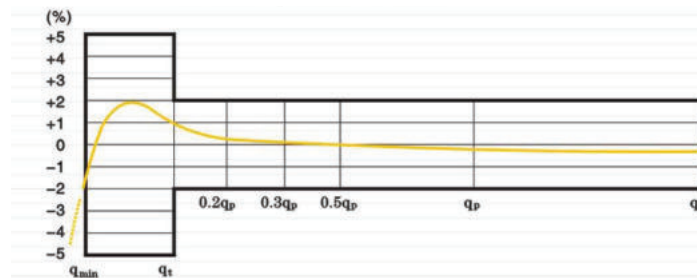

DIMENSIONS AND WEIGHT

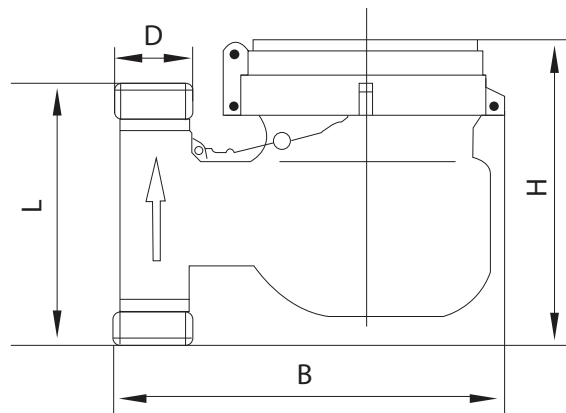

Size (mm)	L Length	B Width	H Height	Weight (KG)
15	95	135	120	1.5
20	99	150	130	1.7
25	110	160	130	3.0

Water temperature: $\leq 50^{\circ}\text{C}$ for cold water meter
 Water temperature: $\leq 90^{\circ}\text{C}$ for hot water meter
 Working pressure: $\leq 1.0\text{Mpa}$